

1 Install the Magnetic Mount Antenna

Mount the Magnetic Mount Antenna on the outside of your vehicle, on a horizontal surface that will always face the sky. The antenna contains a strong magnet that will stick to any metal part of your vehicle, but will not damage the vehicle.

For most vehicles the best location is on the roof above the front windshield, as close to being centered between the left and right sides as the cable length will allow. For convertible vehicles that do not have room above the windshield, place the antenna on the hood of the vehicle at a corner nearest the windshield. Consult a professional installer if your vehicle roof or hood is non-metallic (i.e. fiberglass), or you have difficulty finding a location for your antenna.

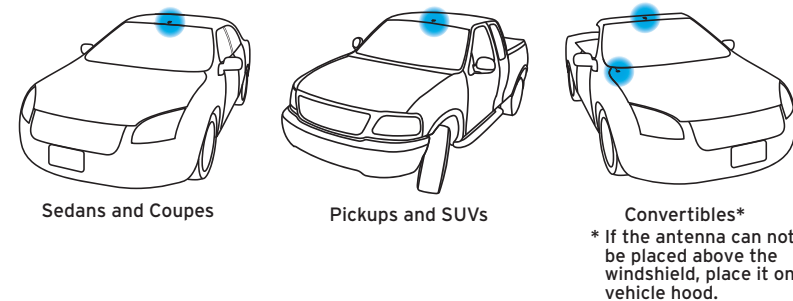

TIP: When mounting the Magnetic Mount Antenna, be sure that the area is clean and dry by using the Alcohol Prep Pad. Avoid locating the antenna near other antennas (i.e. GPS, Cellular, or AM/FM) as well as roof rack or other items that can obstruct the view to the satellites.

If you are installing the antenna at the roof edge, or hood edge, install the Cable Routing Adapter to direct the antenna cable downward.

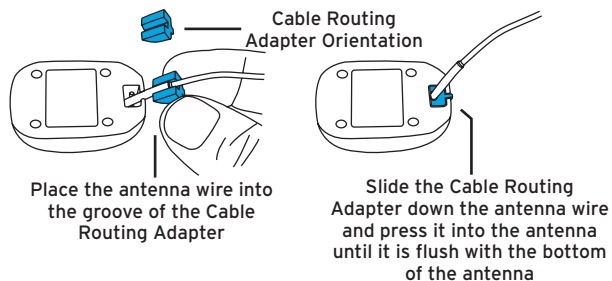

When routing the antenna cable, press the antenna wire under the rubber molding around the front windshield to the nearest corner. Then route the cable out of the windshield molding and into the rubber weather stripping around the door opening. Lift the weather stripping from the opening and tuck the cable inside it, then replace the weather stripping. Run the cable inside of the weather stripping to the bottom of the door opening. Hide the antenna wire inside the cabin. Pull the cable out of the weather stripping at the bottom of the door opening and route it under the carpet toward the cigarette lighter power adapter socket. Coil any excess cable in a hidden location, such as under the carpet, keeping it away from any vehicle pedals or controls. Secure the excess cable with wire ties.

TIP: Always be careful to include enough slack in your routing to accommodate open doors or the hood lid. Use electrical tape to secure the cable in areas so that hinges do not pinch the cable with the door.

Plug the Magnetic Mount Antenna connector into the **ANTENNA** connector on the Snap! base. The antenna plug and cable will fit into the recess on the top of the Snap! base.

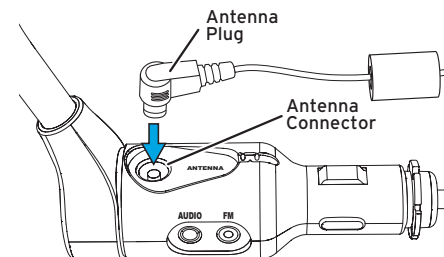
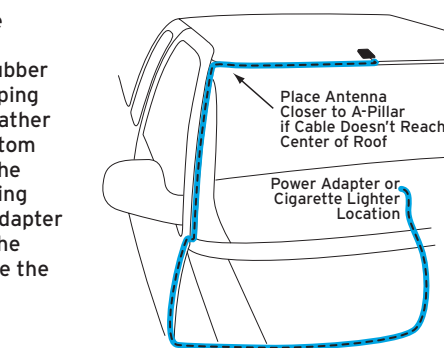

2 Find a Location for the Snap!

The Snap! mounts into your vehicle's cigarette lighter or power adapter socket. If your vehicle has more than one, be sure to choose the one that doesn't interfere with the driver's vision or access to driving controls, the one which won't interfere with the deployment of airbags or other safety equipment, and makes the Snap! easily accessible for operation.

NOTE: After plugging the Snap! into the cigarette lighter socket and connecting the cables, remember to route the cables so they do not interfere with the safe operation of the vehicle.

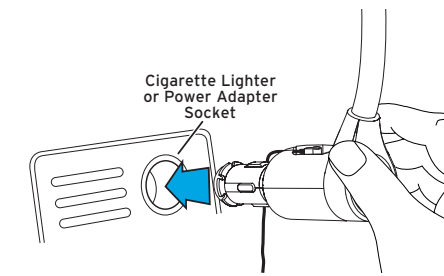

3 Activate Snap!

Before proceeding with connecting the audio, the Courtesy Period included with your Snap! needs to be activated:

- Be sure the vehicle is outside and the antenna has a clear view of the sky.
- Power on your Snap! by pressing the **Power** button.
- When Snap! powers on, after the **Welcome to XM** message, you will be prompted to **Press 1, 2, 3 To Begin**. Press the number button 1, then 2, then 3.
- If the Magnetic Mount Antenna has been installed correctly, and Snap! is receiving the XM signal, a **Courtesy Period Begun** message will verify that the Courtesy Period has begun. You will then be notified about the length of the Courtesy Period and prompted to set up the audio connection.
- Snap! will then tune to channel 247. Although at this point you have access to all the channels, leave it tuned to channel 247 until you have set up the audio connection.

If **Acquiring Signal**, **Chk Antenna Connection**, or **No Signal Chk Antenna** is displayed instead of the **Trial Period Has Begun** message, this indicates that you are not receiving the XM signal. Be sure the vehicle is outside and the antenna has a clear view of the sky. Verify that you have installed and connected the antenna as described. Also refer to "Mount the Magnetic Mount Antenna" on page 14 of the User Guide.

Refer to "Troubleshooting" on page 36 of the User Guide for additional help.

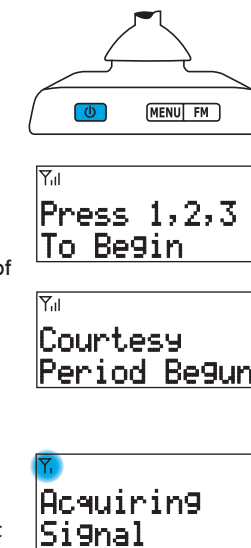

4 Connect the Audio

To play audio through your vehicle's stereo or FM radio, decide on one of the following audio connection options:

Option 1: Best: Use the provided **Aux In Cable** if your vehicle's stereo system has an auxiliary input connection. Plug one end of the cable into the **AUDIO** connector on the Snap!, and the other end into the auxiliary input connection on the vehicle's stereo system. Refer to your vehicle's owners manual to find the location of the auxiliary input jack, or consult the vehicle dealer. Turn on your vehicle's stereo system and set it to play input from the auxiliary input source (or cassette mode if using a cassette adapter). You should now hear the XM audio. The installation is complete; proceed to step 5 to subscribe.

Audio Quality	GOOD	BETTER	BEST
FM Direct Adapter (FMDA)			★
Aux In Cable			★
Cassette Adapter		★	
PowerConnect	★		

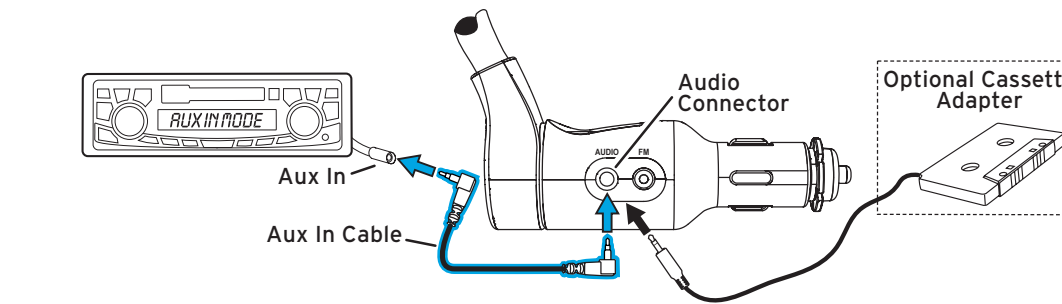

TIP! The auxiliary input jack may be located on the face plate of the vehicle radio, on the back of the radio, anywhere on the front dash panel, inside the glove compartment, or inside the center console in between the front seats.

Option 2: Good: Use the **PowerConnect** feature of the Snap!. **PowerConnect** plays the audio through your vehicle's FM radio.

- You'll first need to find an available FM channel. An available FM channel is one that's not being used by an FM radio station in your area. When you tune your FM radio to an available channel, you should only hear static or silence - not talk or music. We recommend the following method to find an available FM channel:
Manually tune through your local FM channels on your vehicle's FM radio. Locate and create a list of channels that aren't being used by any FM radio station. Write down the list. Once you have created your list of available FM channels, you will need to find the one that provides the best match for Snap!.

TIP! You'll need to use the 'Manual' tune function on your vehicle's FM radio to tune through every FM channel one-by-one. Turn on your vehicle's FM radio. Start at 88.1 and use the 'Manual' tune function on your vehicle's FM radio to tune through each FM channel one-by-one (88.1 followed by 88.3 etc.) to locate channels that aren't being used by a local FM radio station. Write down each FM channel that has only static or silence on it, until you reach 107.9.

- Pick the first FM channel on your list from step 1. Turn on your vehicle's FM radio (if you have not already done so) and tune it to this FM channel.

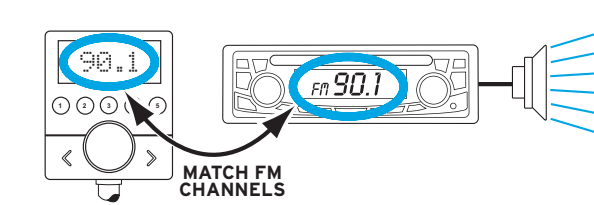

- Set your Snap! to transmit on the same FM channel that you have selected in step 1:

- Press the FM button on the top of the Snap!.
- Rotate the Control knob to select the available FM channel you choose in step 1.
- You should hear the XM channel 247 through your vehicle's FM radio. If you are satisfied with the sound quality installation is complete. If you are not, move to the next FM channel on your list, and tune your vehicle's FM radio and Snap! to this new FM channel. Continue until you have found an FM channel with which you are satisfied.

- Once you have found a satisfactory FM channel to use, press and hold 1 until the 1 button is illuminated. This FM channel is now set as FM preset 1.

- Press the FM button or wait 10 seconds to exit the FM setup.

- The audio level output of the Snap! can be increased or decreased as necessary to match the audio levels of other sources in your vehicle. Refer to "Set Audio Level" on page 32 of the User Guide.

- If the signal reception is good, but there is no audio when tuned to channel 247, verify that both the Snap! and your vehicle's FM radio are tuned to the same FM channel (steps 2 & 3). Also ensure the chosen FM channel is a suitable one to use in your area (step 1). Also be sure that the audio level is set high enough to be heard (step 5). Refer to "Troubleshooting" on page 36 of the User Guide for additional help.

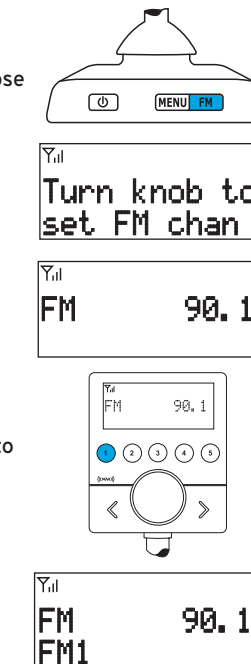

5 Subscribe

The Snap! works on the XM network and requires a XM subscription. Before you can start listening, please do the following:

- Make sure your Snap! is turned on, and receiving the XM signal so that you can hear the XM audio.
- Make a note of your Radio ID. You can find it by pressing **menu**, on a label on the bottom of the gift box, and on the label on the back of your Snap!.
- To subscribe:
 - Online: Go to www.siriusxm.ca
 - OR
 - By phone: Call 1-877-GET-XMSR (1-877-438-9677)
- Activation usually takes 10 to 15 minutes, but may take up to an hour. We recommend that your Radio remain on until subscribed. Once your radio is subscribed, any messages related to the Courtesy Period will not appear on the display.

Snap! Button Functions and Main Display

Snap! Button Functions

Number Buttons

Press to select your favourite channels, press and hold to set a favourite channel; also press to select an FM channel preset, press and hold to set an FM channel preset.

Control Knob

Rotate to tune to the previous or next channel within the current category; also rotate to tune FM channels.

Scan Button

Press to start or stop a scan of each channel within the current category.

The Main Display

When listening to a channel, information about what is currently playing is displayed. The screen will alternate between the artist name and song title, and the current category name and channel name.

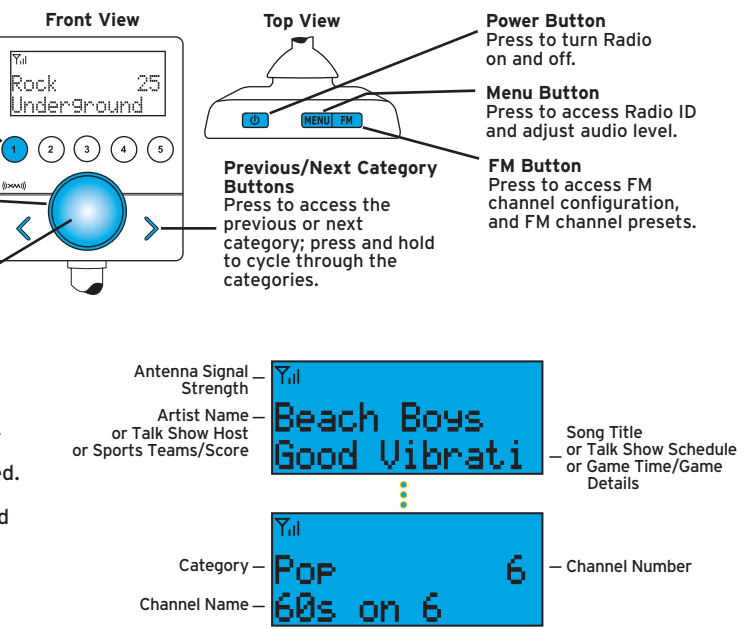

What's in the Box?

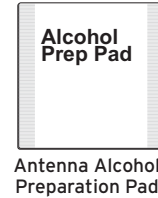
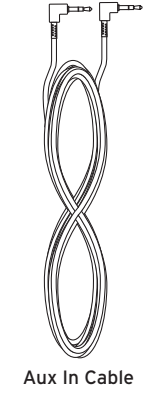
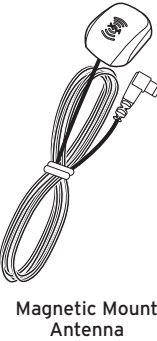
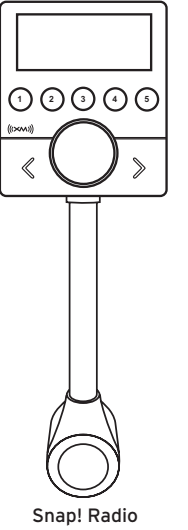

www.siriusxm.ca

Sirius XM Canada Inc.
135 Liberty St. - 4th floor
Toronto, Ontario, M6K 1A7

1-877-438-9677

© 2012 SIRIUS XM Radio Inc.
XDPIV10SG 120719a



Quick Start Guide

Snap!
In-vehicle Radio

CAUTION! Do not attempt to install, activate, or adjust any of the setting options described in this Quick Start Guide unless your vehicle is parked in a safe location.